

2009 MOTO

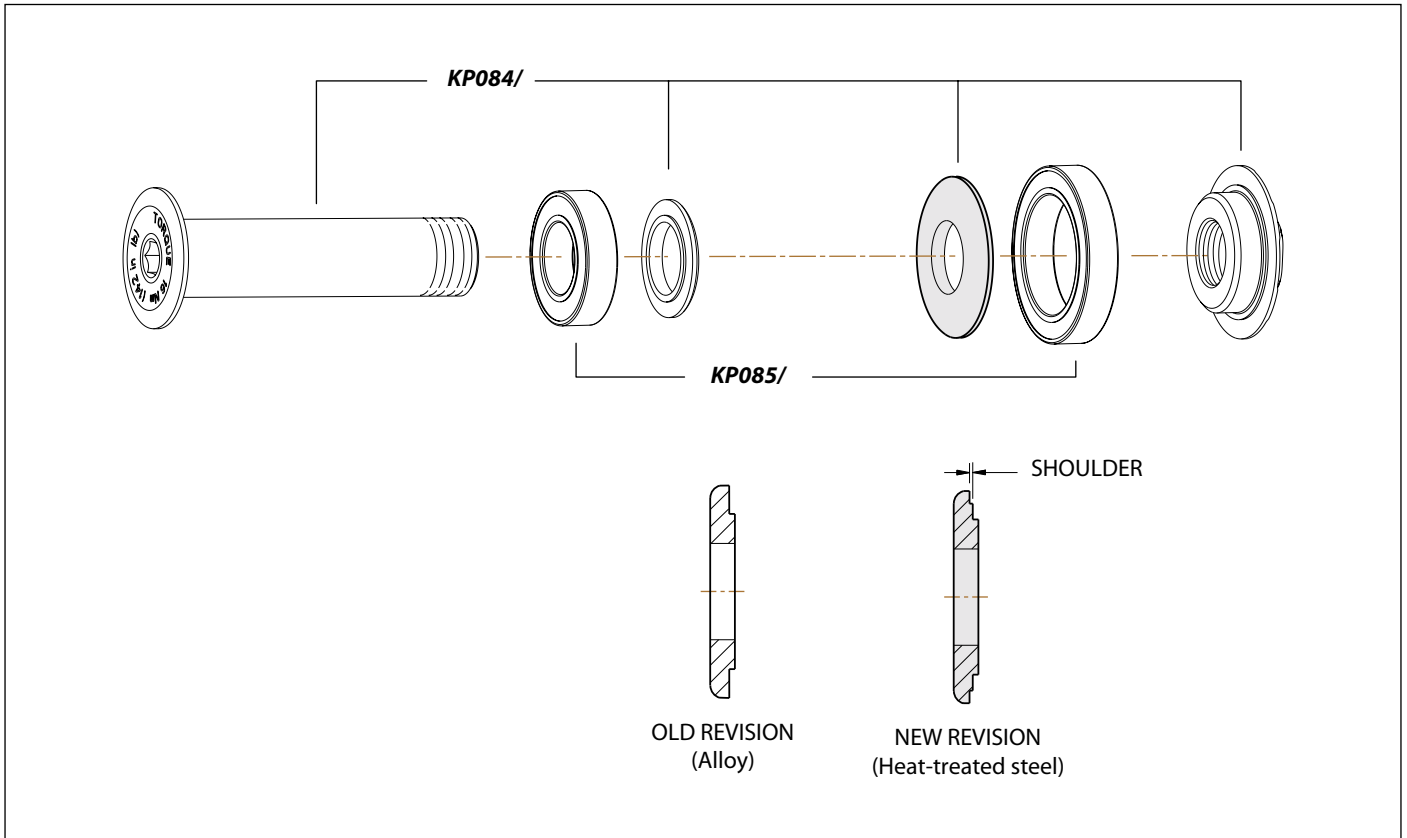

Main Pivot Assembly Update

The non-drive side pivot spacer (shaded above) of both MOTO Carbon and MOTO Alloy frames has been updated. The part material has been changed from alloy to heat-treated steel and a small SHOULDER to fit against the non-drive side bearing. The new revision spacer will be less susceptible to damage from over-torquing the main nut (item 6). The new spacer design can be identified visually without disassembly since it is bronze in color and magnetic. The older revision spacer is silver in color and is non-magnetic. The new revision spacer is included in Cannondale kit **KP084/**.